

# DATA SHEET



## Three Phase Induction Motor - Squirrel Cage

Customer :

Product line : Rolled Steel JM Pump NEMA Premium Efficiency Three-Phase  
 Product code : 13180568  
 Catalog # : 00718ET3E213JM-S

Frame	: 213/5JM	Locked rotor time	: 32s (cold) 18s (hot)
Output	: 7.5 HP (5.5 kW)	Temperature rise	: 80 K
Poles	: 4	Duty cycle	: Cont.(S1)
Frequency	: 60 Hz	Ambient temperature	: -20°C to +40°C
Rated voltage	: 230/460 V	Altitude	: 1000 m.a.s.l.
Rated current	: 18.4/9.18 A	Protection degree	: IP55
L. R. Amperes	: 134/67.0 A	Cooling method	: IC411 - TEFC
LRC	: 7.3x(Code J)	Mounting	: F-1
No load current	: 8.81/4.41 A	Rotation <sup>1</sup>	: Both (CW and CCW)
Rated speed	: 1770 rpm	Noise level <sup>2</sup>	: 60.0 dB(A)
Slip	: 1.67 %	Starting method	: Direct On Line
Rated torque	: 22.3 ft.lb	Approx. weight <sup>3</sup>	: 127 lb
Locked rotor torque	: 260 %		
Breakdown torque	: 300 %		
Insulation class	: F		
Service factor	: 1.15		
Moment of inertia (J)	: 0.9380 sq.ft.lb		
Design	: B		

Output	25%	50%	75%	100%	Foundation loads	
Efficiency (%)	89.4	90.2	91.0	91.7	Max. traction	: 392 lb
Power Factor	0.39	0.64	0.76	0.82	Max. compression	: 518 lb

		<u>Drive end</u>	<u>Non drive end</u>
Bearing type	:	6209 ZZ	6206 ZZ
Sealing	:	V'Ring	Without Bearing Seal
Lubrication interval	:	-	-
Lubricant amount	:	-	-
Lubricant type	:	Mobil Polyrex EM	

Notes  
 USABLE @208V 20.1A SF 1.00 SFA 20.1A

This revision replaces and cancel the previous one, which must be eliminated.  
 (1) Looking the motor from the shaft end.  
 (2) Measured at 1m and with tolerance of +3dB(A).  
 (3) Approximate weight subject to changes after manufacturing process.  
 (4) At 100% of full load.

These are average values based on tests with sinusoidal power supply, subject to the tolerances stipulated in NEMA MG-1.

Rev.	Changes Summary	Performed	Checked	Date
Performed by				
Checked by			Page	Revision
Date	12/03/2025		1 / 1	

A  
B  
C  
D  
E

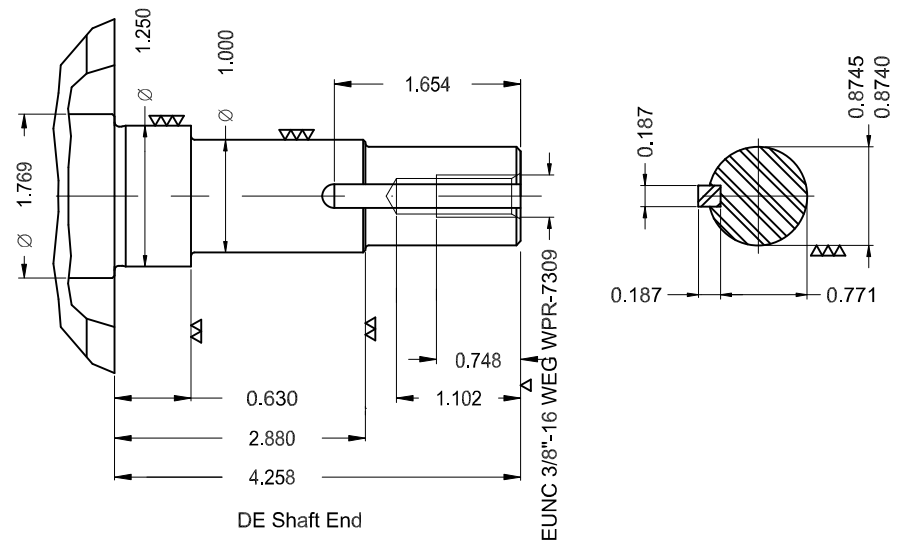
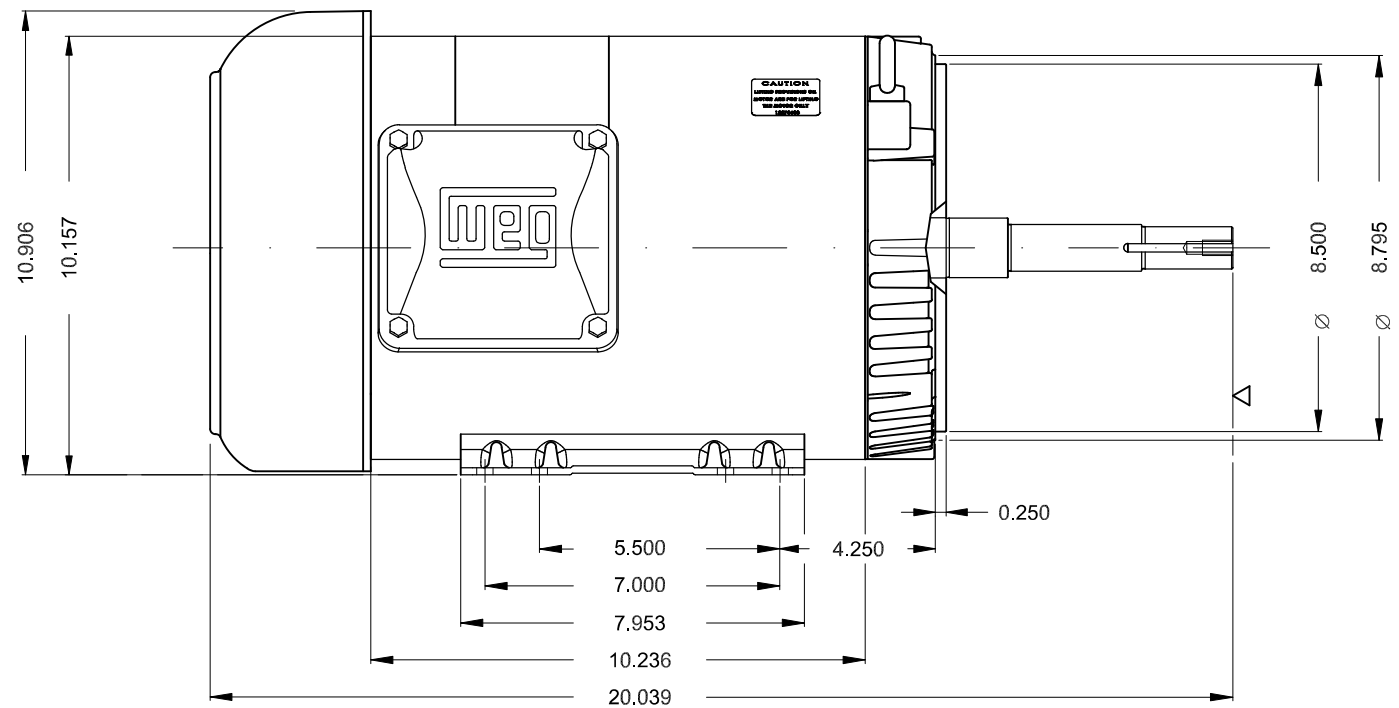
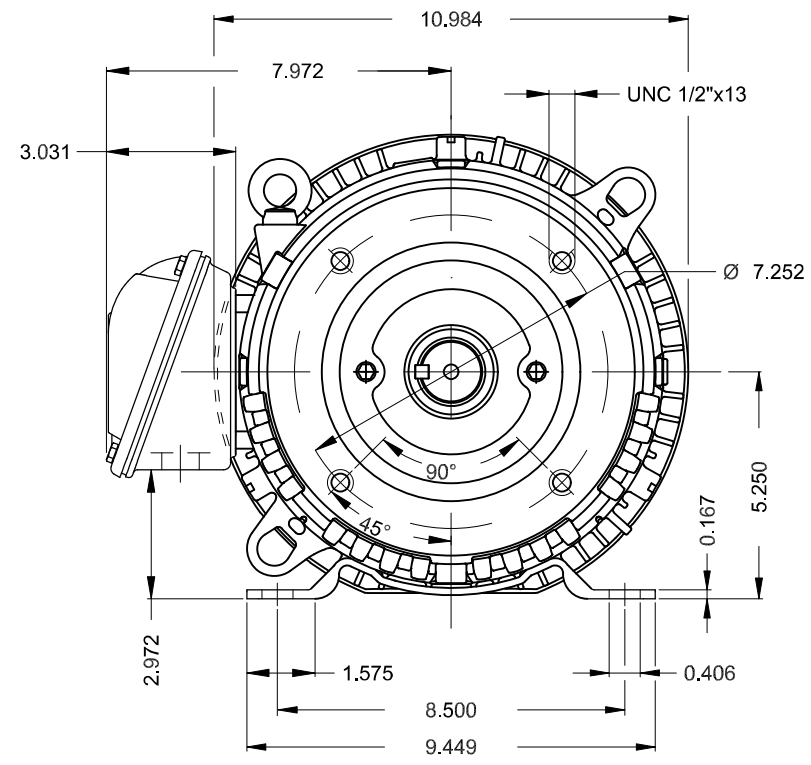
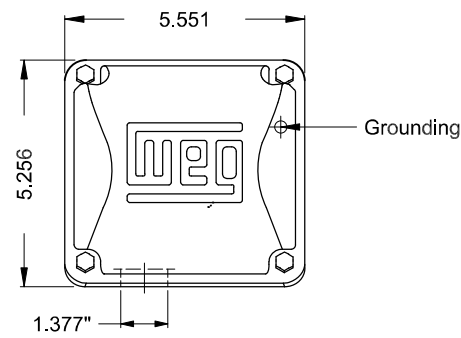

Color Munsell N 1 matte black					
Painting plan 207N					
Mounting B34D					
				HYBRISUSER	00
ECM	LOC	SUMMARY OF MODIFICATIONS	EXECUTED	CHECKED	RELEASED DATE VER
EXECUTED	HYBRISUSER	THREE PH. MOTOR ROLLED STEEL JM NEMA PREM. EFF.			
CHECKED		FRAME 213/5JM IP55 TEFC			
RELEASED					
REL. DATE	WMO	Jaragua do Sul	Product Engineering	WDD	00
			SHEET	1 / 1	

7.5 HP 04 Poles 60 Hz

A





MADE IN MEXICO

MAT: 13180568 CC029A  
W01.TE0IC0X0N  
MODEL 00718ET3E213JM-S



FOR SAFE AREA



For 60Hz: Class I, Zone 2, IIC  
Class I, Div.2, Gr. A,B,C,D - T3  
Div 2 Inverter Duty (SF1.00)  
CT 2:1/VT 1000:1

PH 3	Hz 60	HP 7.5
FR 213/5JM		kW 5.5
DUTY CONT.		V 230/460
ALT 1000 m.a.s.l		A 18.4/9.18
INS CL F AT 80K	IP55	SFA 21.2/10.6
AMB 40°C	DES B	SF 1.15
ENCL TEFC	CODE J	PF 0.82
		RPM 1770
		NEMA NOM. EFF 91.7%

ALTERNATE RATING: 7.5HP 50Hz 190-220/380-415V SF1.00  
22.0-19.4/11.0-10.3A 1455RPM EFF 88.6% (IE2) IEC 60034-1

For safe area-inverter duty motor For 60Hz use on VPWM 1000:1 VT, 4:1 CT

DE 6209-ZZ ODE 6206-ZZ MOBIL POLYREX EM



T1-BLU T2-WHT  
T3-ORG T4-YEL  
T5-BLK T6-GRY  
T7-PNK T8-RED  
T9-RED BRK



INTERCHANGE ANY TWO LINE WIRES TO REVERSE THE ROTATION

WARNING: Motor must be grounded in accordance with local and national electrical codes to prevent serious electrical shocks. Disconnect power source before servicing unit.

AVERTISSEMENT: Le moteur doit être mis à la terre

conformément aux codes électriques locaux et nationaux afin d'éviter tout choc électrique grave. Déconnectez l'alimentation avant l'entretien de la machine.

