

# DATA SHEET

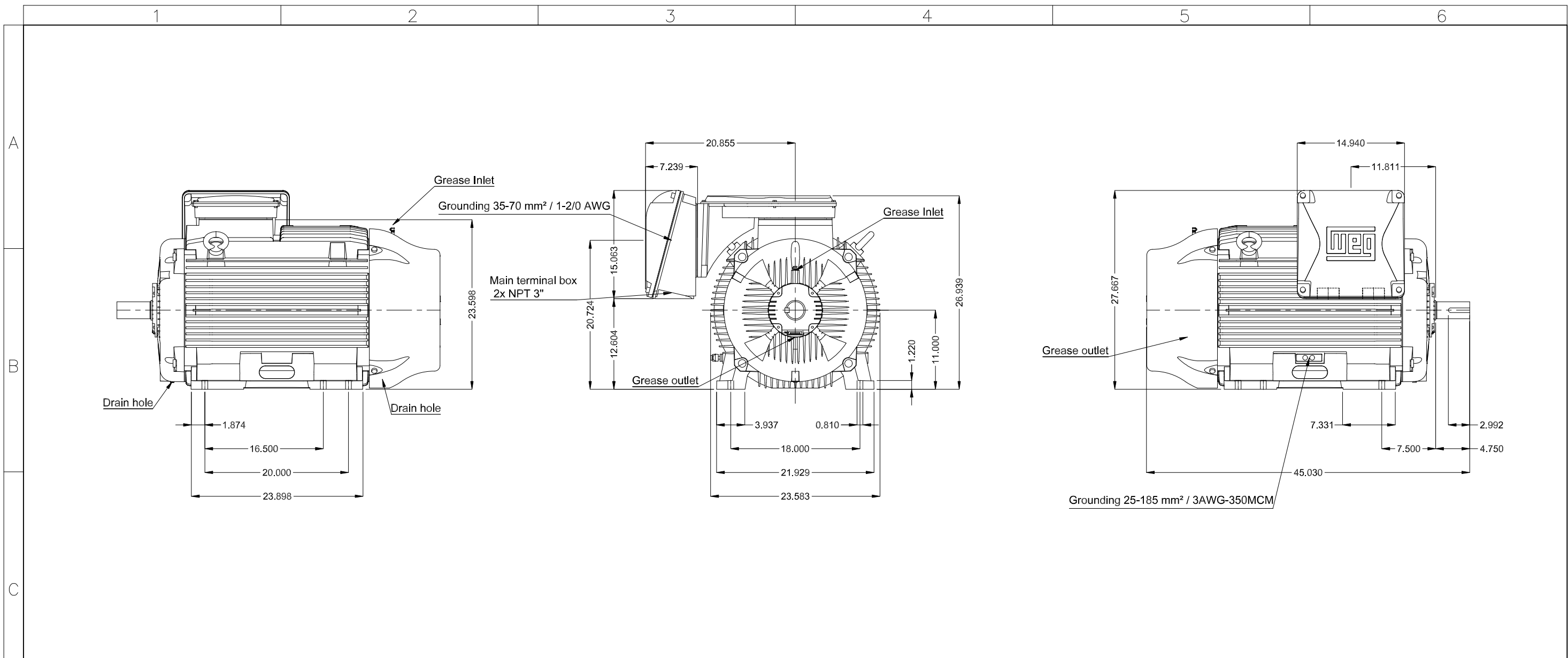

## Three Phase Induction Motor - Squirrel Cage

Customer :						
Product line		: W22 NEMA Premium Efficiency Three-Phase		Product code :		13472771
				Catalog # :		25018ET3G447TS-W22
Frame : 445/7TS Output : 250 HP (185 kW) Poles : 4 Frequency : 60 Hz Rated voltage : 460 V Rated current : 281 A L. R. Amperes : 1827 A LRC : 6.5x(Code G) No load current : 90.0 A Rated speed : 1780 rpm Slip : 1.11 % Rated torque : 738 ft.lb Locked rotor torque : 229 % Breakdown torque : 240 % Insulation class : F Service factor : 1.15 Moment of inertia (J) : 89.6 sq.ft.lb Design : B			Locked rotor time : 27s (cold) 15s (hot) Temperature rise : 80 K Duty cycle : Cont.(S1) Ambient temperature : -20°C to +40°C Altitude : 1000 m.a.s.l. Protection degree : IP55 Cooling method : IC411 - TEFC Mounting : F-1 Rotation <sup>1</sup> : Both (CW and CCW) Noise level <sup>2</sup> : 73.0 dB(A) Starting method : Direct On Line Approx. weight <sup>3</sup> : 2523 lb			
Output		25%	50%	75%	100%	Foundation loads
Efficiency (%)		95.7	95.8	96.2	96.2	Max. traction : 4177 lb
Power Factor		0.50	0.75	0.83	0.86	Max. compression : 6700 lb
Losses at normative operating points (speed;torque), in percentage of rated output power						
P1 (0,9;1,0)	P2 (0,5;1,0)	P3 (0,25;1,0)	P4 (0,9;0,5)	P5 (0,5;0,5)	P6 (0,5;0,25)	P7 (0,25;0,25)
4.2	3.5	3.1	2.1	1.5	1.0	0.6
			<u>Drive end</u>		<u>Non drive end</u>	
Bearing type :			6314 C3		6314 C3	
Sealing :			WSeal		WSeal	
Lubrication interval :			12000 h		12000 h	
Lubricant amount :			27 g		27 g	
Lubricant type :			Mobil Polyrex EM			
Notes						
This revision replaces and cancel the previous one, which must be eliminated. (1) Looking the motor from the shaft end. (2) Measured at 1m and with tolerance of +3dB(A). (3) Approximate weight subject to changes after manufacturing process. (4) At 100% of full load.				These are average values based on tests with sinusoidal power supply, subject to the tolerances stipulated in NEMA MG-1.		
Rev.	Changes Summary			Performed	Checked	Date
Performed by						
Checked by					Page	Revision
Date	11/03/2025				1 / 1	



250 HP 04 Poles 60 Hz		A							
Scale 1 : 14									
HYBRISUSER		00							
ECM	LOC	SUMMARY OF MODIFICATIONS	EXECUTED CHECKED RELEASED DATE VER						
EXECUTED	HYBRISUSER	THREE PH. MOTOR W22 NEMA PREM. EFF.	<table border="1"> <tr> <td colspan="2">PREVIEW</td> </tr> <tr> <td>WDD</td> <td>00</td> </tr> <tr> <td>SHEET</td> <td>1 / 1</td> </tr> </table>	PREVIEW		WDD	00	SHEET	1 / 1
PREVIEW									
WDD	00								
SHEET	1 / 1								
CHECKED		FRAME 445/7TS IP55 TEFC							
RELEASED									
REL. DATE									

TS shaft end  
 Color RAL 5009  
 Painting plan 203A  
 Mounting NEMA F-1  
 Mounting B3R(D)

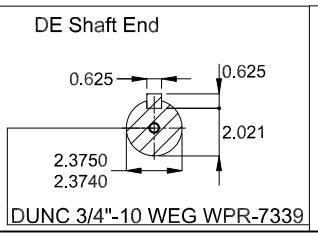

MADE IN MEXICO  
13472771



MODEL 25018ET3G447TS-W22



FOR SAFE AREA  
Mod. TE1BFOXON  
CC029A



Class I, Div 2, Gr A, B, C, D - T3  
Class I, Zone 2, IIC - T3  
Class II, Div 2, Gr F, G - T3C  
For use on PWM: Gr. A, B, C, D, F,  
VT 1000:1, CT 20:1, 1.00SF - T3

Inverter Duty Motor  
Severe Duty

PH3 60Hz Fr. 445/7TS 1000m.a.s.l. IP55 TEFC 2411lb

V 460

A 281

HP 250

kW 185

SF 1.15

SFA 323

RPM 1780

PF 0.86

AMB 40°C

INS cl. F DT80K

NEMA NOM EFF 96.2%

DUTY CONT.

DES B Code G

PART-WINDING



WYE-DELTA



→ 6314-C3 (27g)

→ 6314-C3 (27g)



MOBIL POLYREX EM (12000h)

